



Redevelopment Authority of the City of Erie

Client: 608 East 10th Garage
Property: 608 East 10th
Erie, PA 16501

Operator: DNIES

Estimator: Dan Nies

Type of Estimate:

Date Entered: 11/19/2024

Date Assigned:

Price List: PAER8X_OCT24

Labor Efficiency: Restoration/Service/Remodel

Estimate: 608EAST10THGARAGE

Note: Measurements taken by RACE Inspectors are estimates only and should not be used by Contractors for bidding purposes. Contractors need to take their own measurements for bid calculations.

All work is to be in accordance with RACE specifications and the 2009 edition of the IRC. Any work not in compliance of these standards and codes will be removed and replaced.

All Lead Hazard control work will conform to HUD Guidelines and all Pennsylvania Labor & Industry standards.

Any overages of relocation time will be the responsibility of the Contractor. The need for additional relocation time must be noted on this bid package.

This scopes pricing will include all applicable Municipal permits/fees and any required Municipal inspections or review fees required by the jurisdiction of this project.



608EAST10THGARAGE

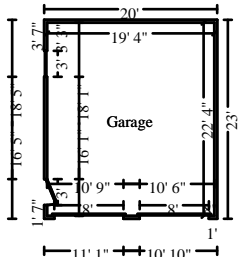

Garage

Height: 8'

666.67 SF Walls	431.78 SF Ceiling
1098.44 SF Walls & Ceiling	431.78 SF Floor
47.98 SY Flooring	83.33 LF Floor Perimeter
83.33 LF Ceil. Perimeter	

DESCRIPTION

QTY

1. Remove all overgrown ivy/vegetation from all surfaces	1.00 EA
2. Remove overhead door & hardware	1.00 EA
3. Frame in removed OH door opening	1.00 EA
- Match existing framing	
4. Plywood over removed OH door	100.00 SF
5. Plywood over window	10.00 SF
- Window should not be removed	
6. Paint plywood over removed OH door and window	1.00 EA
- Match as close as possible to existing building color	
7. R&R One new overhead garage door & hardware	1.00 EA
- Includes any necessary framing	
- Manual lifting. Automatic opener not required	
8. R&R New exterior door	1.00 EA
- Sized same as existing door	
9. Door lockset & deadbolt	1.00 EA

Line item total _____

NOTES:

Roof

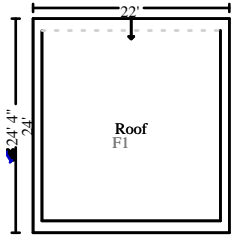

Roof

535.28 Surface Area
92.66 Total Perimeter Length

5.35 Number of Squares

DESCRIPTION

QTY

10. Furring strip over existing roof - Main sloped section only. Front eyebrow/parapet to remain	550.00 SF
11. Metal roofing applied over furring strips - Main sloped section only. Front eyebrow/parapet to remain. - Includes all necessary terminations, trim, and flashing	550.00 SF

Line item total

NOTES:

Labor Minimums Applied

DESCRIPTION

QTY

19. Painting labor minimum	1.00 EA
----------------------------	---------

NOTES:



Grand Total Areas:

1,333.33 SF Walls	863.56 SF Ceiling	2,196.89 SF Walls and Ceiling
863.56 SF Floor	95.95 SY Flooring	83.33 LF Floor Perimeter
0.00 SF Long Wall	0.00 SF Short Wall	83.33 LF Ceil. Perimeter
431.78 Floor Area	460.00 Total Area	666.67 Interior Wall Area
920.96 Exterior Wall Area	86.00 Exterior Perimeter of Walls	
535.28 Surface Area	5.35 Number of Squares	92.66 Total Perimeter Length
0.00 Total Ridge Length	0.00 Total Hip Length	

Remove all overgrown vegetation from all walls

Board over and paint plywood

New door with lockset & deadbolt

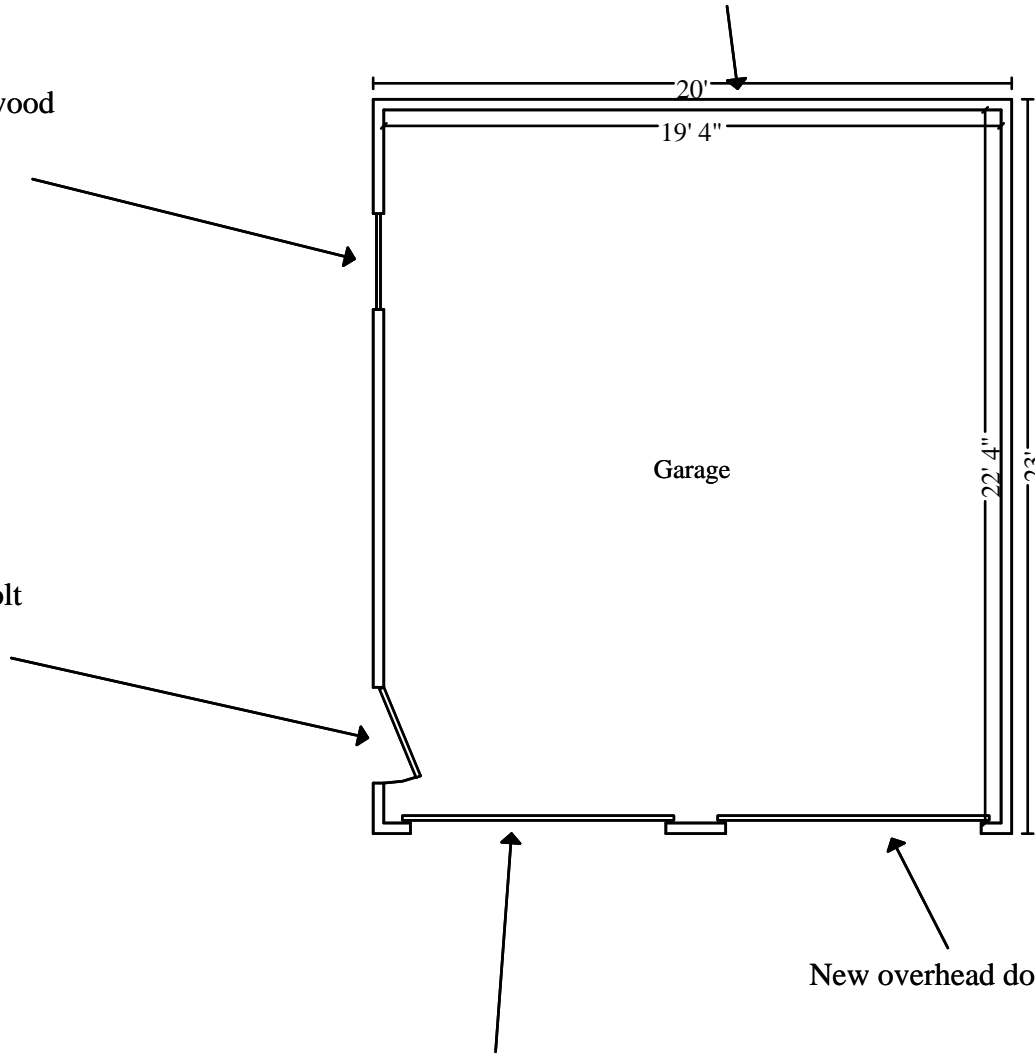

Remove OH door
Frame in opening
Install sheathing and paint

Garage

New metal roofing installed over existing with furring strips

